

# BikeYoke REVIVE 272

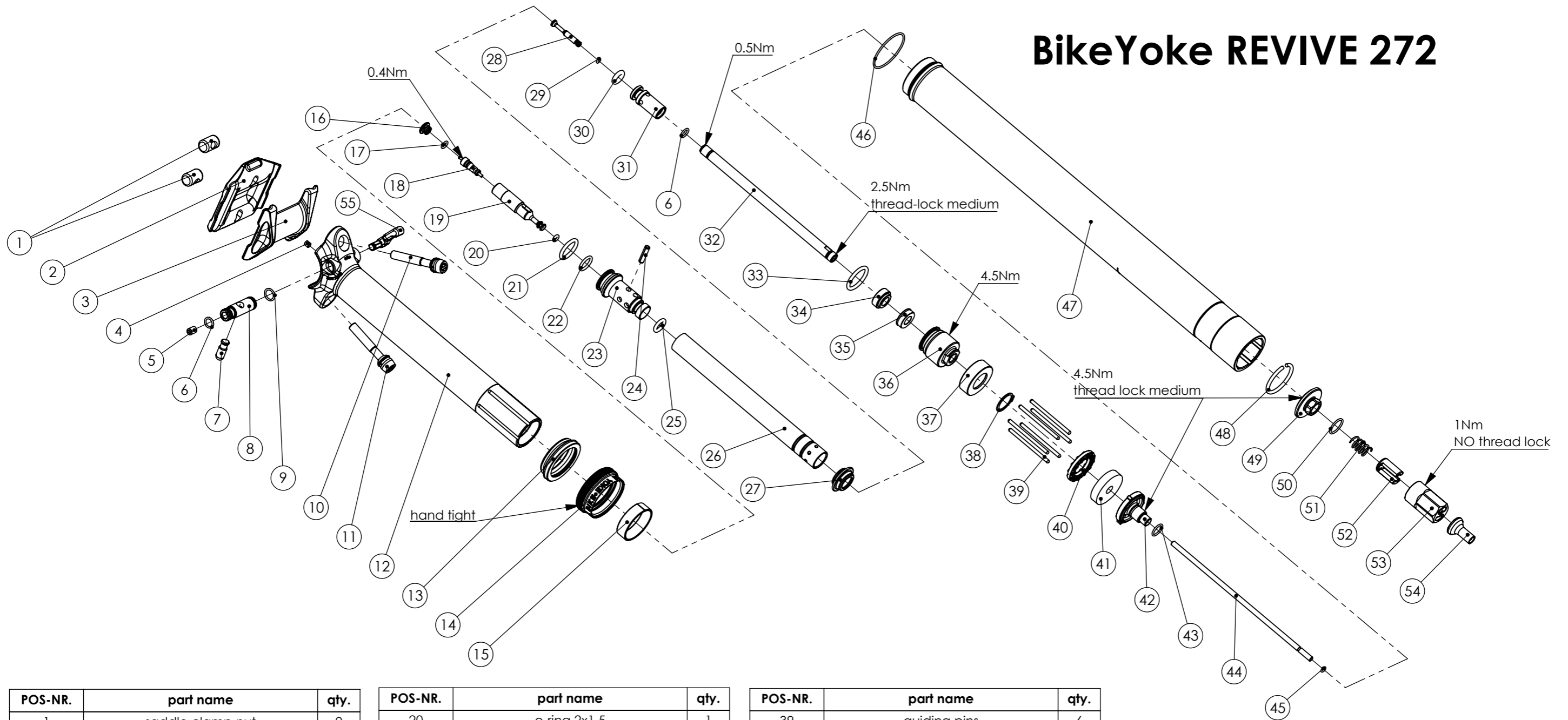

POS-NR.	part name	qty.
1	saddle clamp nut	2
2	upper saddle clamp	1
3	lower saddle clamp	1
4	set screw ISO 4026 flat head M3x3	1
5	set screw ISO 4026 flat head M4x5	1
6	o-ring 5x1	2
7	reset lever	1
8	reset axle	1
9	o-ring 6x1	1
10	saddle clamp bolt long	1
11	saddle clamp bolt short	1
12	REVIVE 272 upper tube	1
13	REVIVE 272 wiper	1
14	REVIVE 272 wiper collar	1
15	REVIVE 272 upper bushing	1
16	valve plug	1
17	o-ring 3.5x1	1
18	valve core	1
19	REVIVE plunger	1

POS-NR.	part name	qty.
20	o-ring 2x1.5	1
21	o-ring 11.5x2	1
22	o-ring 8x1.5	1
23	REVIVE 272 reset head	1
24	spring pin 3x12	1
25	o-ring 6x2	1
26	REVIVE 272 inner tube	1
27	REVIVE 272 Microvalve	1
28	REVIVE 272 valve needle	1
29	o-ring 1.5x1	1
30	o-ring 5x2.5	1
31	REVIVE 272 piston	1
32	REVIVE 272 shaft	1
33	o-ring 14x2	1
34	REVIVE 272 sealhead bushing	1
35	u-cup seal	1
36	REVIVE 272 sealhead	1
37	REVIVE 272 lower bushing	1
38	circlip DIN 471 12	1

POS-NR.	part name	qty.
39	guiding pins	6
40	REVIVE 272 bottom out bumper	1
41	REVIVE 272 foam ring	1
42	REVIVE 272 upper retaining plate	1
43	o-ring 7x1	1
44	REVIVE 272 push rod	1
45	o-ring 2x1	1
46	o-ring 25x1	1
47	REVIVE 272 lower tube	1
48	REVIVE 272 lower tube retaining ring	1
49	REVIVE 272 lower retaining plate	1
50	o-ring 9.5x1	1
51	preload spring	1
52	actuating plunger	1
53	connector nut	1
54	housing endcap	1
55	quick reset lever	1

**Recommended grease:**  
**BikeYoke Dropper Goo**  
**r.s.p. Slick Kick**  
**SRAM Butter**  
**KS Post Paste**  
**Buzzy's Slick Honey**

**Don't use spray-on lubricants!**

**Cartridge oil: Bikeyoke Sanguine**  
**viscosity: 16cSt @ 40°C**  
**fill volume: 18ml**

**Other suspension oils with similar viscosity may work, but differ in performance.**