

# BIKEYOKE DIVINE SL / Rascal

POS	part name	qty.
1	saddle clamp nut	2
2	upper saddle clamp	1
3	DIVINE (SL) lower saddle clamp	1
4	saddle clamp bolt	2
5	valve cap	1
6	valve core	1
7	valve housing	1
8	upper tube unit	1
9	wiper	1
10	wiper collar	1
11	upper bushing	1
12	o-ring 16x2.5	1
13	piston	1
14	o-ring 2.5x1.5	2
15	main valve	1
16	piston shaft	1
17	o-ring 17x2	1
18	shaft bushing	1
19	cartridge sealhead	1
20	u-cup seal	1
21	lower bushing	1
22	lower bushing circlip	1
23	guiding pins	6
24	o-ring 18x3.5	1
25	foam cover ring	1
26	inner retaining plate	1
27	o-ring 6x1	1
28	actuator rod	1
29	o-ring 2x1	1
30	o-ring 29x1	1
31	lower tube	1
32	retaining ring	1
33	outer retaining plate/nut	1
34	o-ring 9.5x1	1
35	actuating plunger	1
36	connector nut	1
37	housing endcap	1

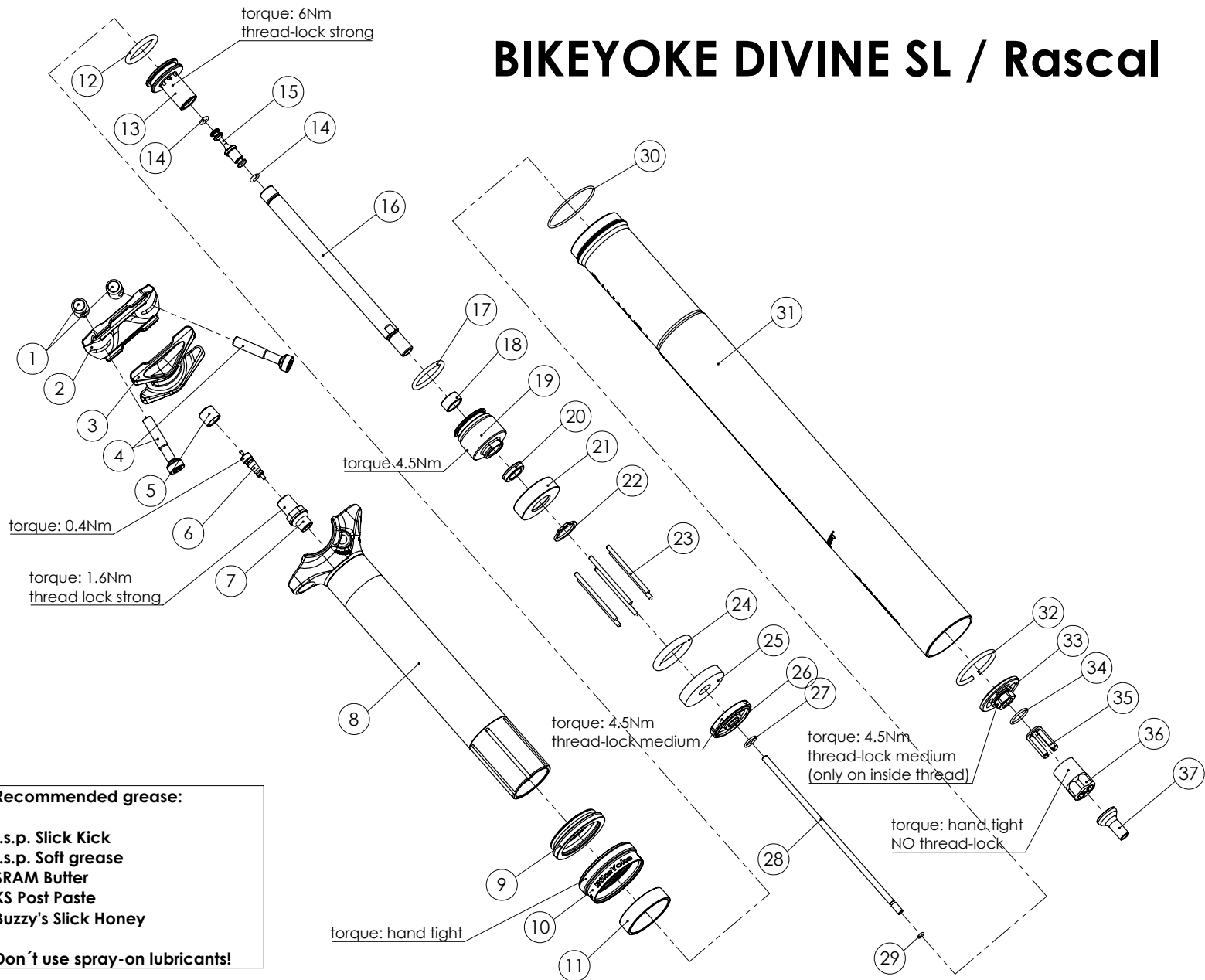

### Recommended grease:

r.s.p. Slick Kick  
r.s.p. Soft grease  
SRAM Butter  
KS Post Paste  
Buzzy's Slick Honey

**Don't use spray-on lubricants!**

Cartridge oil volume = 8ml

BikeYoke recommends 96% Mobil DTE 10 Excel 15 with 4% r.s.p. No Stick Slip.  
Other suspension oils with similar viscosity will work, but may differ in performance.