

POS	part name	qty.
1	barrel nut M5	2
2	upper saddle clamp 3.0	1
3	lower saddle clamp 3.0	1
4	saddle clamp bolt M5x40	1
5	saddle clamp bolt M5x37	1
6	DIN 913 M4x5	1
7	DIN 913 M3x3	1
8	o-ring 5x1	1
9	reset axle	1
10	o-ring 6x1	1
11	mini reset lever	1
12	reset finger	1
13	REVIVE upper tube	1
14	valve plug	1
15	o-ring 3.5x1	1
16	valve core	1
17	reset valve needle	1
18	o-ring 2x1.5	1
19	o-ring 11.5x2	1
20	o-ring 8x1.5	1
21	spring pin DIN 1481 - 3x12	1
22	reset unit sealhead	1
23	o-ring 8x2	1
24	REVIVE inner tube	1
25	REVIVE Microvalve	1
26	o-ring 7x2.5	1
27	backup ring	1
28	REVIVE piston	1
29	valve spring	1
30	o-ring 2x1.5 NBR 90	1
31	REVIVE main valve needle	1
32	o-ring 2.5x1.5	1
33	piston rod	1
34	actuator rod	1
35	o-ring 17x2	1
36	sealhead DU bushing	1
37	REVIVE cartridge sealhead	1
38	u-cup	1
39	REVIVE wiper	1
40	REVIVE upper DU bushing	1
41	REVIVE lower tube	1
42	guiding pin	6
43	REVIVE lower bushing	1
44	circlip DIN 471 - 12	1
45	REVIVE bottom out bumper	1
46	REVIVE foot plate	1
47	foam ring 7x28x5	1
48	o-ring 24 x2	1
49	REVIVE foot 3.0	1
50	pin 2x8	1
51	pin 3x13	2
52	actuator lever 3.0	1
53	actuator rocker 3.0	1
54	circlip DIN 472 - 28	1
55	cable barrel 3.0	1
56	DIN 6799 1.9	2

recommended grease:
 BikeYoke Dropper Goo
 Buzzy's Slick Honey
 Rock Shox Dynamic Grease
 r.s.p. Slick Kick
Don't use spray-on lubricants!

hydraulic fluid:
 BikeYoke Sanguine
 viscosity: 16cSt @ 40°C
 Other suspension oils of similar viscosity will typically work - performance may vary

oil volumes:
 125mm = 36ml
 160mm = 42ml
 185mm = 46ml
 213mm = 55ml
tolerance: -0/+2ml

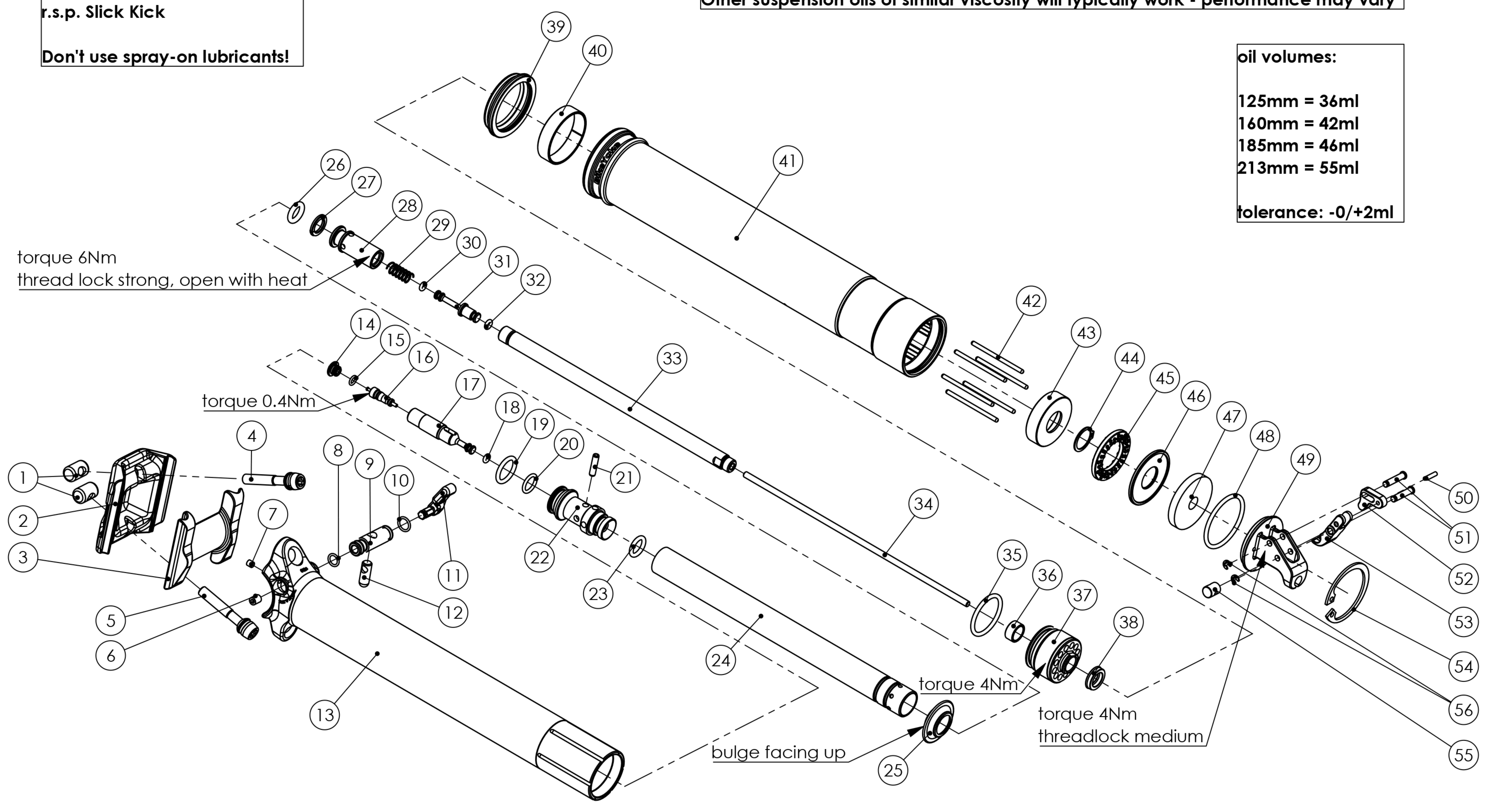

air pressure (fully extended):
 250psi - 300psi max
Only inflate in full extended position and with post upright!

BikeYoke REVIVE THREE (30.9/31.6)

